

DIST.

A TERMINI DI LEGGE E' VIETATA LA RIPRODUZIONE O LA NOTIFICAZIONE DI QUESTO DISEGNO A TERZI SENZA AUTORIZZAZIONE

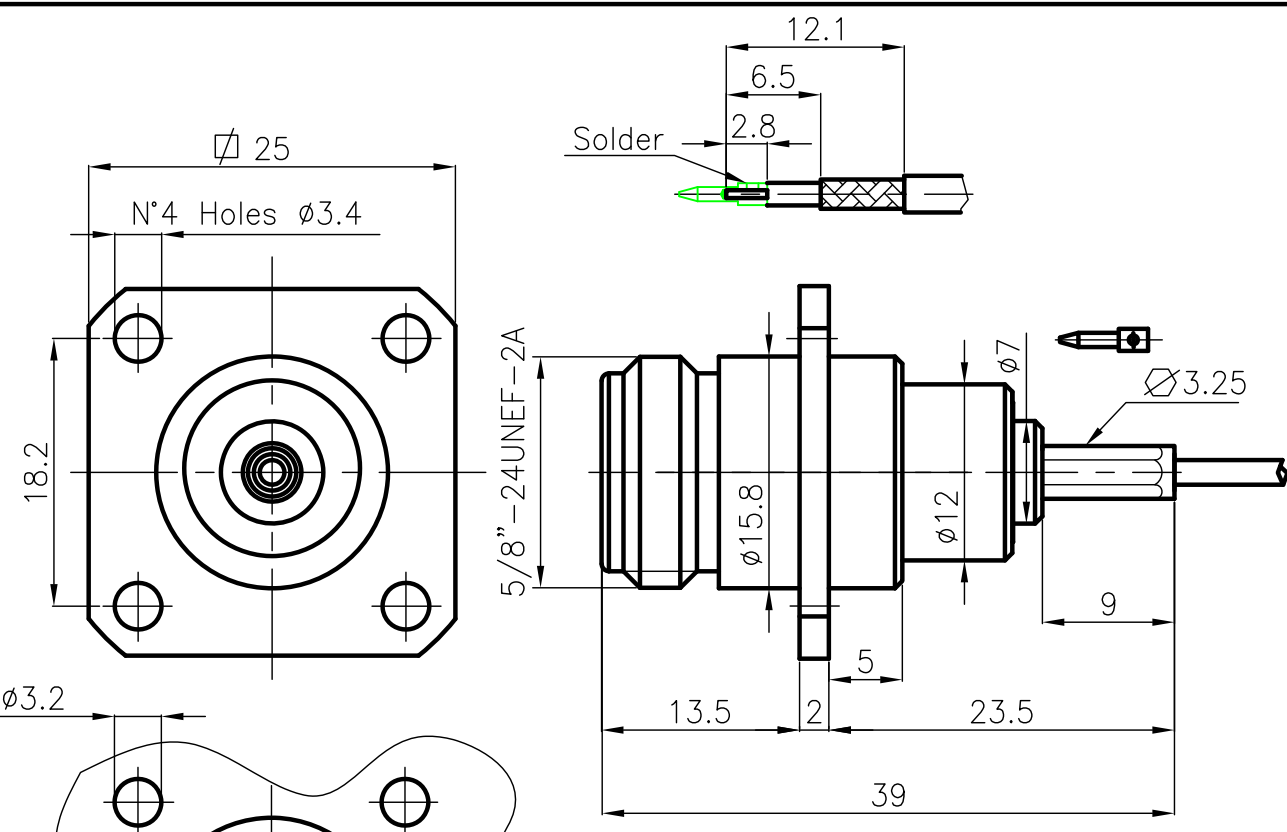

PANEL CUTOUT DIMENSIONS

SPECIFICATIONS

Mating and dimensions

as per CECC 22210

ELECTRICAL

Frequency range

0 ÷ 1 GHz

VSWR

≤ 1.10 (25 dB)

MATERIALS AND FINISH

Body

Brass

Ni 3μ min.

Center contact

Beryllium copper

Au 1.27μ

Insulator

PTFE

Crimping Ferrules

Soft Copper

Ni 3μ

For cables : RG316 U ; RG188 A/U

DENOMINAZIONE
50 Ohm - N SERIES COAXIAL CONNECTOR
BULKHEAD STRAIGHT SOCKET
SOLDER-CRIMP TYPE



| | |
|--------|--------------|
| ISSUED | 13.06.03 |
| REV. | N° MOD. DATA |

SCALA 2:1
FILE NPD7101C

CONTR. Cucchi I
APPROV. A.Q. Cucchi M

DATA 16.06.03
DIS. Torti E.

N° CODICE
NPD.71.001