

DIST.

A TERMINI DI LEGGE E' VIETATA LA RIPRODUZIONE O LA NOTIFICAZIONE DI QUESTO DISEGNO A TERZI SENZA AUTORIZZAZIONE SCRITTA.

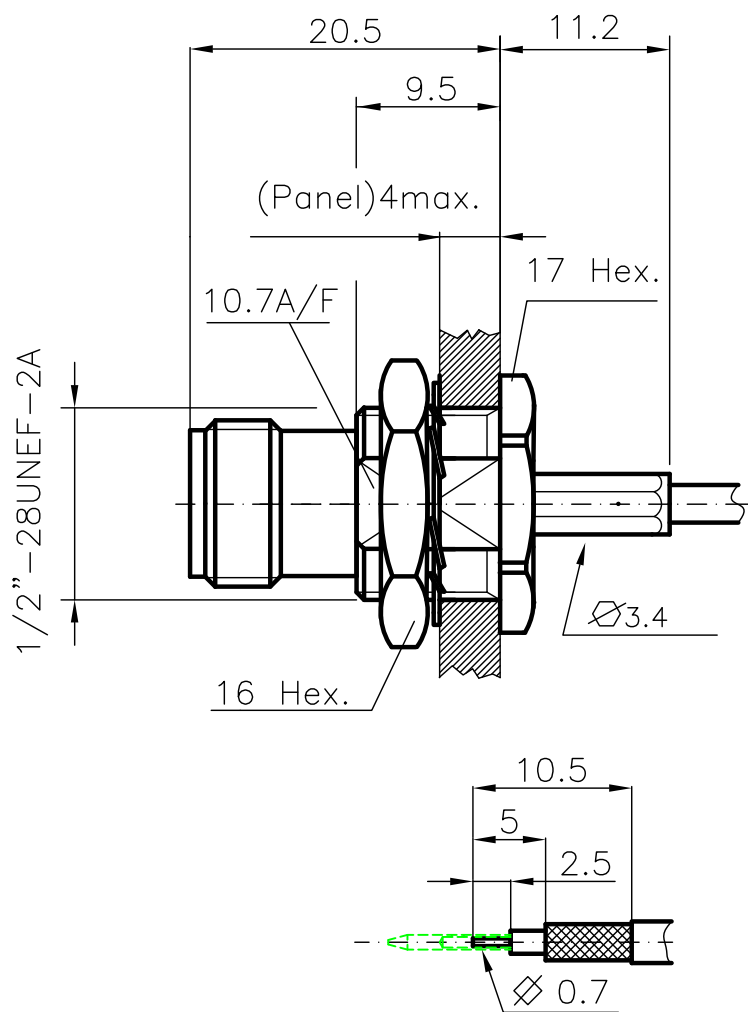

PANEL CUTOUT DIMENSIONS

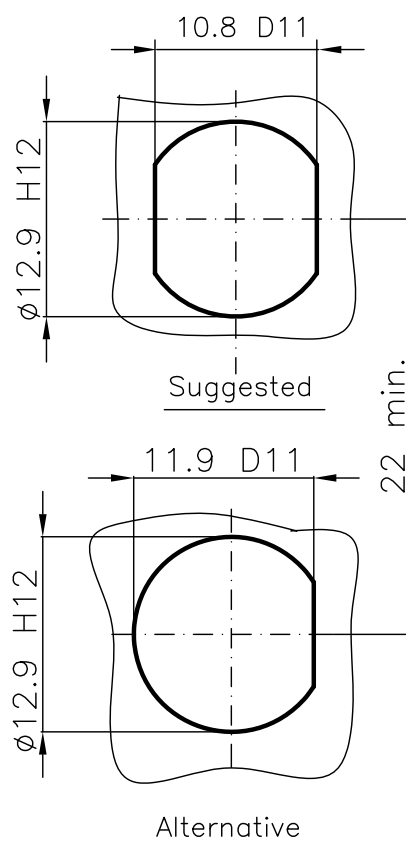

SPECIFICATIONS

Mating and dimensions as per CECC 22200

MATERIALS AND FINISH

Body and locknut	Brass	Ni 3 μ
Center contact	Beryllium Copper	Au 1 μ
Insulator	PTFE	
Shakeproof	Bronze	Ni 3 μ
Crimping ferrule	Soft Copper	Ni 3 μ

For cables : RG 316 D.S.

MOD. 101C

			DENOMINAZIONE		
			50 Ohm.-TNC SERIES CONNECTOR-BULKHEAD STRAIGHT SOCKET WITH CRIMP ATTACHMENT		
SCALA		2:1	CONTR.		Cucchi I
DATA		14.03.03	APPROV.A.Q.		Cucchi M.
FILE		HPD5901C	DIS.		Torti E.
REV.	N° MOD.	DATA			
/	ISSUED	14.03.03			



N° CODICE
HPD.59.001